

Alex Reade

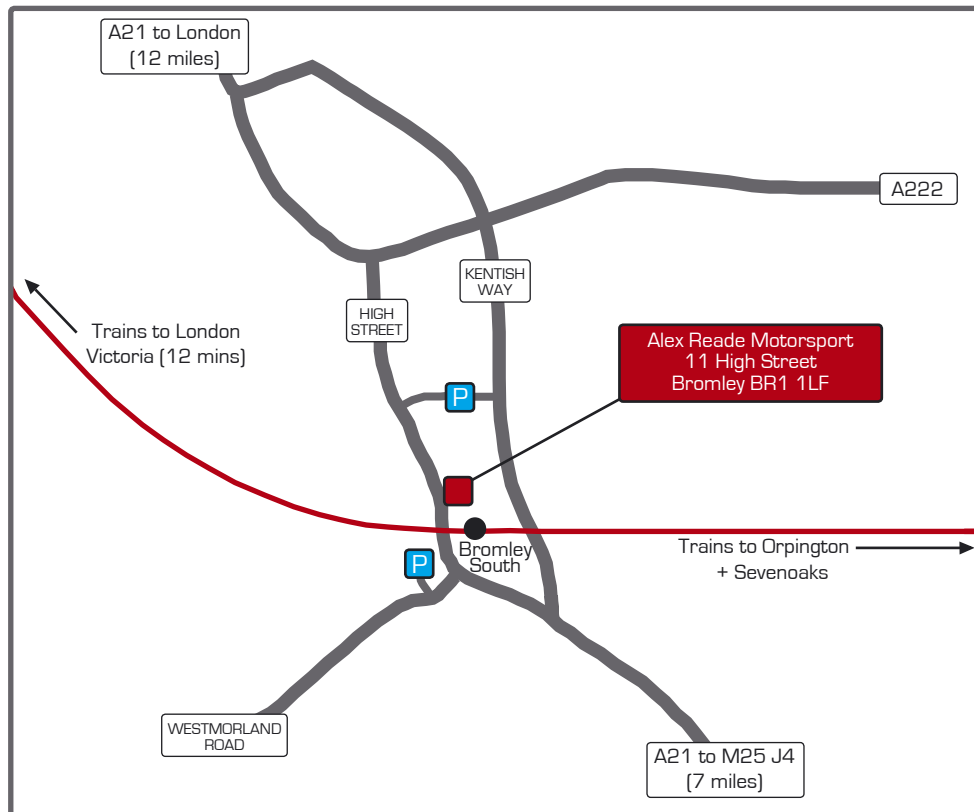

M O T O R S P O R T

11 High Street Bromley BR1 1LF
T: 0870 224 0646 E: sales@alexreade.net
www.alexreade.net



Travelling By Road from South (M25)

As London's largest borough Bromley is very accessible by road. From the South the A21 leads directly into Bromley from Junction 4 off the M25. Once in Bromley go past Bristol Street Motors, a large Ford dealership, bear left and follow the road down to a set of lights opposite the RBS building at the bottom of the High Street. Turn left at these lights and then first right into the NCP car park. Parking charges are very reasonable. Leave the car park by foot on level 4 which takes you onto the High Street opposite Bromley South rail station. Cross the road and we are about 50 yards on the right.

Travelling By Road from North (London)

Approach Bromley from the A21 which leads from Downham/Lewisham. Lewisham can be reached from London via the A2. The easiest route from the east of London is via the Blackwall Tunnel. Follow the A2 through the tunnel and exit where indicated for Lewisham. Follow the road into Lewisham and you will pick up signs for the A21 Bromley.

The easiest route from central/west London is to cross the river at Vauxhall Bridge, follow signs to the Elephant and Castle where you will pick up signs for the A201/A2. Again follow the A2 until Lewisham where you will pick up signs for the A21 Bromley.

Travelling By Rail

Bromley South is a connecting station for major rail routes from London and the south east. From the south there are direct services from Dover, Ramsgate, Maidstone, Tonbridge and Orpington. From London, Bromley South is serviced with frequent trains from London Victoria, with direct 'fast' services taking only 12 mins. Once at Bromley South exit via the main entrance, turn right and we are about 100 metres on the right.